

Please Keep Carts Off Tees & Greens

Thank You For Your Care

10	11	12	13	14	15	16	17	18	In	Out	Total	Hcp	Net
137	276	417	411	487	320	213	486	201	2948	2547	5495		
3	4	4	4	5	4	3	5	3	35	34	69		
18	16	2	4	8	14	10	6	12					
135	274	415	409	485	318	211	484	199	2930	2529	5459		
3	4	5	5	5	4	3	5	3	37	35	72		
18	16	2	4	8	14	10	6	12					



Kildonan Park Golf Course

Winnipeg, Manitoba

Hole	1	2	3	4	5	6	7	8	9	Out
Yards - Men	302	279	223	200	390	286	293	262	312	2547
Par	4	4	3	3	4	4	4	4	4	34
Handicap	13	17	3	7	1	9	11	15	5	
Yards - Ladies	300	277	221	198	388	284	291	260	310	2529
Par	4	4	4	3	4	4	4	4	4	35
Handicap	13	17	3	7	1	9	11	15	5	

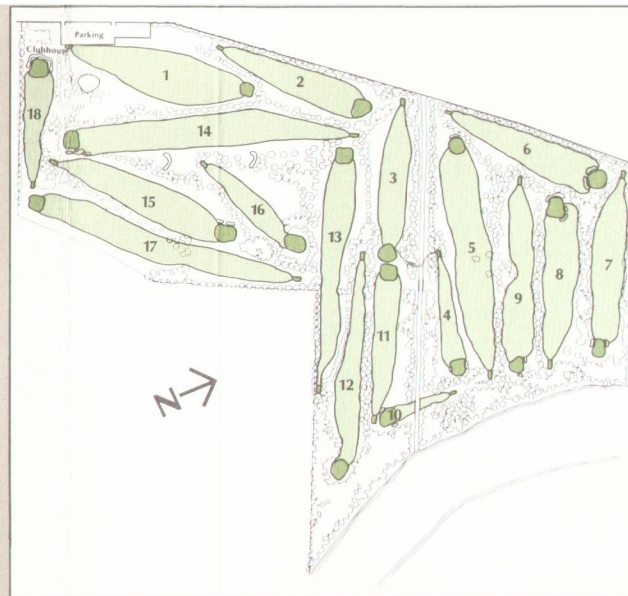

Local Rules

1. In all cases, the Rules of Golf approved by the Royal Canadian Golf Association will govern play on this course.
2. A free lift will be allowed from all newly-planted trees. The ball may be dropped within one club length after relief — not nearer the hole.
3. A free lift will be allowed from all recognized walkways, roadways and protective screens. The ball may be dropped within one club length after relief — not nearer the hole.
4. Golf ball coming to rest near or against perimeter fences and the fences around the houses and maintenance building on Holes 14 and 17 is to be played as it lies. Beyond these fences is "out of bounds" — Rule 27 — Stroke and Distance Penalty.
5. The ditch between Fairways 1 and 14 is played as a lateral water hazard. Proceed under Rule 26. Breach of rule — penalty one stroke.
6. All portions of the "Bergen cutoff" are out of bounds as indicated by the white stakes. Stroke and distance penalty.

Golf Course Regulations

1. Alcoholic beverages are prohibited on the golf course.
2. Players only are permitted on the course — to reduce congestion and to eliminate the possibility of injury, only golfers are allowed on the golf course.
3. Slow players must allow faster players through.
4. Each player must have a set of clubs including bag.
5. Cutting in is not permitted. The course must be played in the proper sequence.
6. Shirts and shoes are required at all times. No swim suits, gym shorts or halter tops allowed.
7. Tee off between markers — in order to distribute wear and tear evenly.
8. Persons violating the above regulations will lose their playing privileges with no refund.

Course Ratings - Men 66 Ladies 69

Player _____

Operated by City of Winnipeg Parks and Recreation Department

CANADA