

GLORY



1

FORESHADOW



2

DEVIL'S CORRIDOR



3

THE PINES

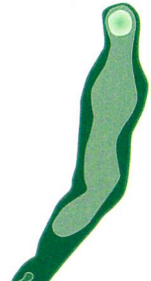

4

THE CHUTE



5

THE RUNWAY



6

SLIPPERY SLOPE



7

HELLO WILLOW



8

GO FOR BROKE



9

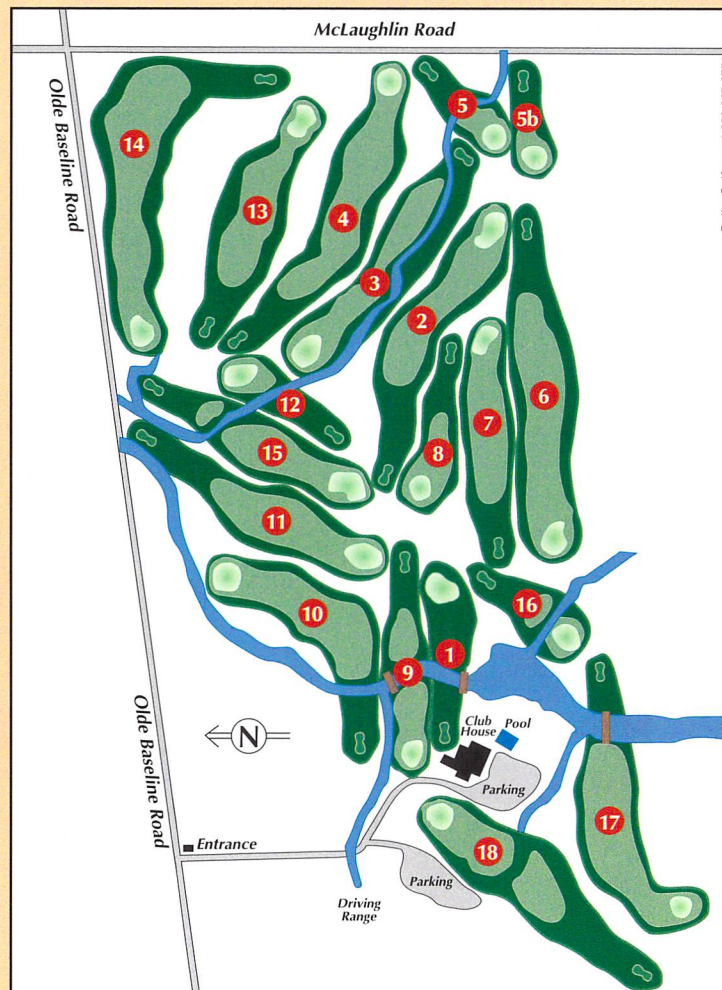

DolcoGolf.com 1 800-267-2751

2121 OLDE BASELINE ROAD, CALEDON, ONTARIO L7C 0K7  
 OFFICE: (905) 838-0200 • FAX: (905) 838-2003  
 E-MAIL: info@golfscaledon.com • www.golfscaledon.com

**Caledon**  
 COUNTRY CLUB



INGLEWOOD • ONTARIO • CANADA

HOLE	1	2	3	4	5	6	7	8	9	OUT
GLORY										
FORESHADOW										
DEVIL'S CORRIDOR										
THE PINES										
THE CHUTE										
THE RUNWAY										
SLIPPERY SLOPE										
HELLO WILLOW										
GO FOR BROKE										
BLUE	239	447	382	471	143	490	327	219	298	3016
WHITE	230	414	375	460	136	460	317	194	269	2855
RED	207	394	352	435	126	430	307	177	245	2673

PAR	4	4/5	4	5	3	5	4	3	4	36/37
MEN'S HCP	17	1	3	5	15	9	11	7	13	
LADIES HCP	13	5	3	1	17	7	11	15	9	

OUT

PLAYER 1	2	3	4	5	6	7	8	9	OUT
PLAYER 2									
+/-									
+/-									
PLAYER 3									
PLAYER 4									

### THE RULES OF PLAY

Rules of the R.C.G.A. govern all play except where modified by local rules.

#### LOCAL RULES

- Free drop not nearer hole if staked trees or telephone poles interfere with stance or swing.
- If ball hits inbound telephone pole, overhead cross-arm or wire, shot must be played over.
- Ball coming to rest on left side fence on the 11<sup>th</sup> hole or on right side of fence on 15<sup>th</sup> hole is Out-of-Bounds. Penalty - Stroke and distance.
- Free drop two club lengths not nearer the hole if ball comes to rest in tree wells on 14<sup>th</sup> fairway.
- Hole #9: Any lay up tee shot entering the hazard as a result of landing on cart path may be dropped short of the hazard or re-teeed - No penalty.

White Stakes: Out of Bounds • Yellow Stakes: Water Hazard • Red Stakes: Lateral Hazard

**ENJOY YOUR GAME!**

HOLE	10	11	12	13	14	15	16	17	18	IN	TOTAL
LEFTY'S DREAM											
OFF THE RAILS											
THE PRAYER											
HIGHER GROUND											
THE SIGNATURE											
ALCATRAZ											
FORGIVENESS											
AMEN											
REDEMPTION											
425	386	165	351	619	341	168	567	464	3486	6502	
379	361	151	345	592	323	146	512	340	3149	6004	
352	331	130	338	547	297	117	494	302	2908	5581	

PAR	4	4	3	4	5	4	3	5	4	36	72/73
MEN'S HCP	8	10	16	14	2	12	18	4	6		
LADIES HCP	8	10	16	6	2	14	18	4	12		

IN TOTAL

PLAYER 1	2	3	4	5	6	7	8	9	10	11	12	13	14	15	16	17	18	IN	TOTAL	HCP	NET
PLAYER 2																					
+/-																					
+/-																					
PLAYER 3																					
PLAYER 4																					

### DISCS ON FAIRWAY

- RED - 100 yds
- WHITE - 150 yds
- BLUE - 200 yds

#### PLEASE...

Play by course rules and follow the etiquette of golf.

Replace all divots and rake all traps.

Repair all ball marks on greens.

Slower players must wave faster groups through.

Follow cart paths.



LEFTY'S DREAM

10

OFF THE RAILS

11

THE PRAYER

12

HIGHER GROUND

13

THE SIGNATURE

14

ALCATRAZ

15

FORGIVENESS

16

AMEN

17

REDEMPTION

18