

Local Rules

- No personal alcoholic beverages or coolers permitted on Golf Course. LLBO Bylaw.
- Soft-spike only. Metal cleats are not permitted. (Soft soled or Soft-spiked golf shoes ONLY)
- Four players to a group. Fivesomes will not be tolerated.
- Please rake bunkers, replace divots and repair ball marks.
- Allow faster players to play through. Adhere to time par. The times on all clocks on the course will read your tee time if playing at a four hour pace. If your clock reads a time that is past your tee time you will need to speed play in order to keep time par pace.
- All players (members and green fee players) must register in the golf shop prior to play.
- Please keep power carts at least 30' from all bunkers, ponds, tees and greens. Cart exit posts are located at the front of every green. Please exit to the rough at or before posts.
- Maximum two minutes searching for lost balls.
- Out of bounds defined by inside edge of white stakes and boundary fence. Penalty - one stroke.
- Water hazards defined by yellow stakes. Lateral hazards defined by red stakes. Both: Penalty - one stroke.
- If a ball strikes a power-line or hydro pole on the 1st, 2nd or 3rd hole, the player must disregard that stroke, abandon the ball and play another ball as nearby to the spot from which the original ball was played, in accordance with rule 20-5.
- Marked drop areas may be used on the 11th and 15th holes for balls coming to rest within the hazards on those holes.
- Relief without penalty from all drainage ditches, ribboned trees, cart paths, driveways, distance markers, plates or stakes, boundary fences, hydro poles and rain shelters. Obtain nearest point of relief, no nearer the hole and drop within one club length. (no nearer the hole)
- Driving range must be treated as out of bounds.

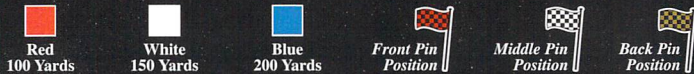

*All yardage discs are measured to the middle of the green.

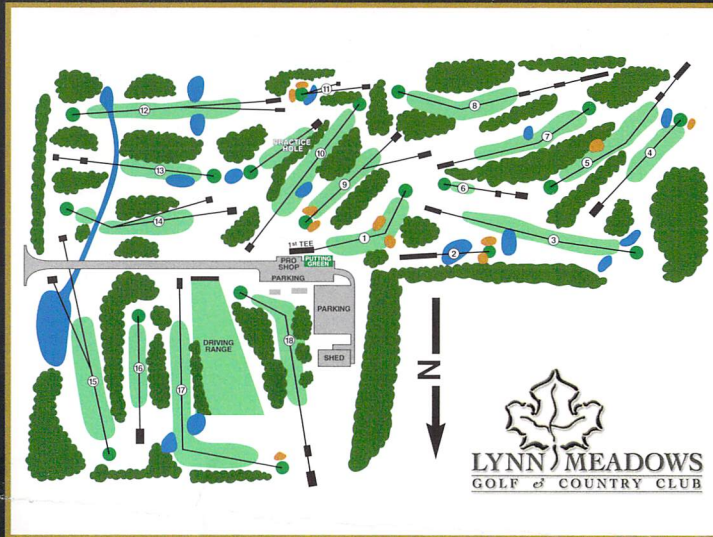

**Tee Time Reservations may be made up to 7 days
in advance for weekend and holiday play.**

**Weekday reservations may be made up to 3 days
in advance for weekday play.**

Power cart reservations are also available.

We welcome small and large tournaments.

Golf lessons and clinics available.

Enjoy your day!



Brant Hill Inn • Luxury All Year

Tel: 519-583-150 • Toll Free: 1-888-741-4419

30 John St., Port Dover, ON N0A 1N7

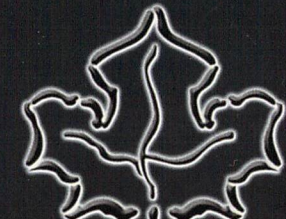

**LYNN MEADOWS
GOLF & COUNTRY CLUB**

Port Dover, Ontario

HOLE	1	2	3	4	5	6	7	8	9	OUT	P L A Y E R	10	11	12	13	14	15	16	17	18	IN	TOT	HCP	NET		
PAR	4	3	5	3	4	3	4	5	4	35			4	3	5	4	4	4	3	5	4	36	71			
BLUE	329	175	498	186	324	175	373	540	367	2967			414	151	506	372	385	379	210	477	350	3244	6211			
WHITE	307	159	468	165	302	155	342	503	350	2751			375	140	458	302	368	311	182	460	339	2935	5686			
HANDICAP	9	15	3	13	11	17	5	1	7				6	18	2	12	8	10	16	4	14					
+/-																										
RED	294	107	432	155	286	121	332	420	305	2452			395	95	437	278	327	302	158	435	294	2721	5173			
HANDICAP	9	17	1	13	11	15	5	3	7			6	18	4	14	8	10	16	2	12						
PAR	4	3	5	3	4	3	4	5	4	35		5	3	5	4	4	4	3	5	4	37	72				

Lynn Meadows Golf & Country Club
580 Lynn Valley Road - R.R. 2, Port Dover, Ontario N0A 1N0

Website: www.lynnmeadowsgolf.com

Phone: (519) 428-9993

Golf Shop	ext. 21	Linda Ball	ext. 22
		Restaurant Manager	
David Grant	ext. 24		
C.P.G.A. Head Professional		Steph Grant General Manager/ Tournament Co-Ordinator	ext. 23
Terry Polischuk Superintendent	ext. 25		
		Fax: (519) 428-3277	

Player: _____ Attested: _____

Player: _____ Date: _____

Player: _____ League/
Tournament: _____

Player: _____ Starting Hole:(for Shot Gun Start) _____

O.G.A. and C.L.G.A. Rating / Slope Rating

Blue: 68.5/118 White: 67.2/114 Red: 64.3/97 C.L.G.A. Red: 69.0/106

ROYAL LEPAGE

Brown Realty
426-7187

The Coffee Shop
Restaurant

Mark Forde
Owner / Chef

309 Main Street
Port Dover, Ontario
N0A 1N0

Tel: 519-583-1483
Toll Free: 1-877-776-6616

Erie Beach Hotel
SINCE 1946



(519) 583-1391

Simcoe HONDA
Dedicated To You

(519) 426-9050

W.J.
HEASLIP
L.T.D.



Nelles Corner R.R. 2, Hagersville, Ont.
www.wjheaslip.com 905-779-3467

R.E. Mann
R.E. MANN BROKERS LTD.

THE INSURANCE PROFESSIONALS
"PEOPLE WHO TAKE AN INTEREST IN PEOPLE"
www.remann.com

49 Norfolk St. N. Simcoe, Ontario
Phone (519) 426-2031
1-800-567-7423

COMMERCIAL - HOME - CONDO - TENANTS - AUTO - FARM - LIFE - TRAVEL



LYNN MEADOWS GOLF & COUNTRY CLUB

castle building centres

STYRES LUMBER
Ohsweken, Ontario N0A 1M0
(519) 445-2944